



# CVBNode 1

**Be part of Singapore's emerging life sciences innovation district**

Our pilot space is more than a collection of labs, offices and meeting rooms. It embodies our vision to create a community where companies build relationships, exchange ideas and advance life science discoveries.

## HIGHLIGHTS

- Curated community events
- Front concierge
- Shared and private labs and offices
- 24/7 access
- Fully Equipped labs
- EHS and operation support
- Shared printer, pantry and meeting rooms
- WIFI and/or private network
- Emergency power



## FLOORPLAN

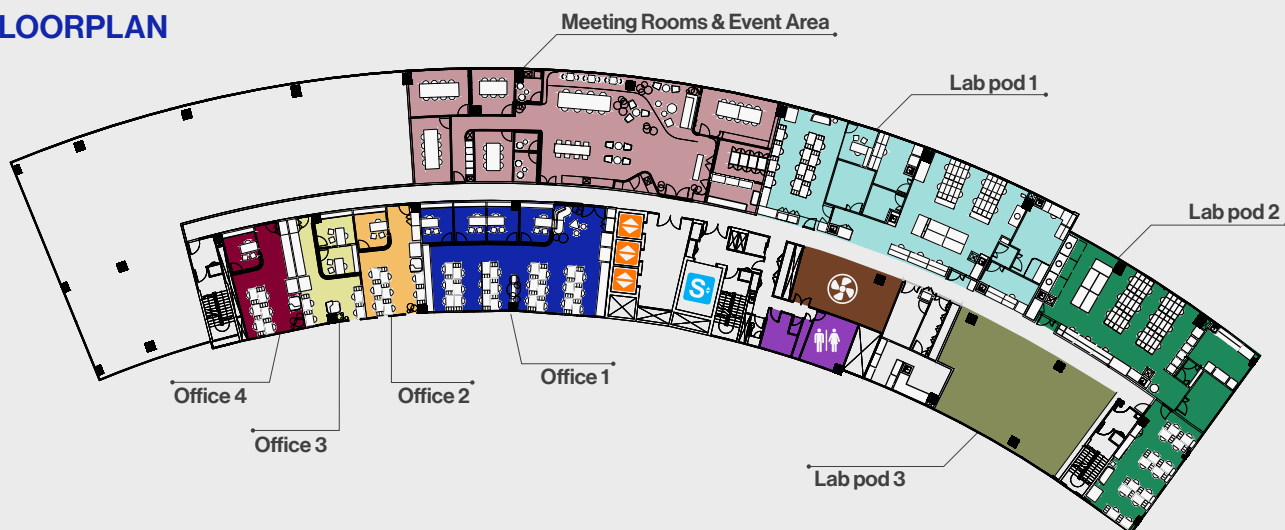

Shared event space/areas >4000 sf

Lab pods from 2500 – 3000 sf (10–20 ppl)

Toilet

Service Lift

Private office spaces from 1200 – 2000 sf (10–25 ppl)

Single desk availability

Passenger Lift

AHU Room

## TECHNICAL SPECIFICATIONS

Floor loading (kN/sqm): 5.0

Floor to slab soffit height (m): 3.8

Passenger lifts: 3 x 1,020 kg (15 ppl)

Service lift: 1 x 2,515 kg

Dimensions: 2.9 m (W) x 2.4 m (D) x 2.4 m (H)

Lift car door size: 2.5 m (W) x 1.9 m (H)

## CONNECTIVITY

Next to the **medical campus of Singapore's largest research university**  
**NUS & NUHS**

10 mins to **Singapore's largest public and academic medical cluster**  
**SGH and DUKE-NUS**

Next to **Singapore's primary government lab site**  
**A\*STAR at one-north**

20 mins to **Singapore's 2<sup>nd</sup> largest research university**  
**NTU**

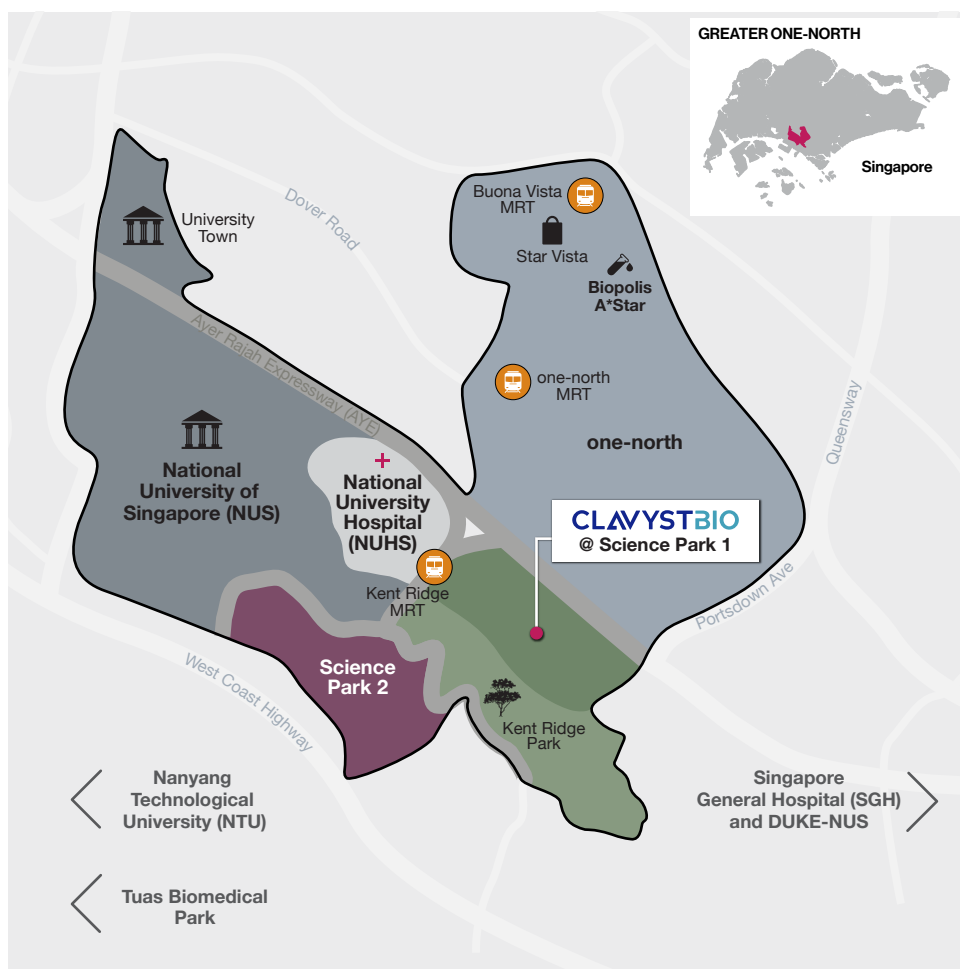

ClavystBio Pte Ltd makes no representations or warranties, conditions, undertakings or terms either expressed or implied as to the condition, quality, accuracy, fitness for purpose, completeness of the information contained herein or that such information will be accurate, up to date, or free from error. All art renderings and pictures herein are artist's impressions only and all specifications stated herein are subject to re-survey and approval from the relevant authorities. The information and specifications contained herein do not form part of an offer or a contract and neither ClavystBio Pte Ltd nor their appointed Marketing Agents can be held for any inaccuracies, changes, losses or damages arising therefrom.