



# CLAVYSTBIO

## NODE 1

### Life Sciences Collaboration Space

Our physical home in the heart of the Singapore Science Park provides critical co-working (lab and office) and collaboration spaces to convene life sciences communities, and foster partnerships across the ecosystem.

### HIGHLIGHTS

- Curated community events
- Emergency power
- Shared and private labs and offices
- 24/7 access
- Shared lab equipment
- EHS and operation support
- Shared printer, pantry and meeting rooms
- WIFI and/or private network

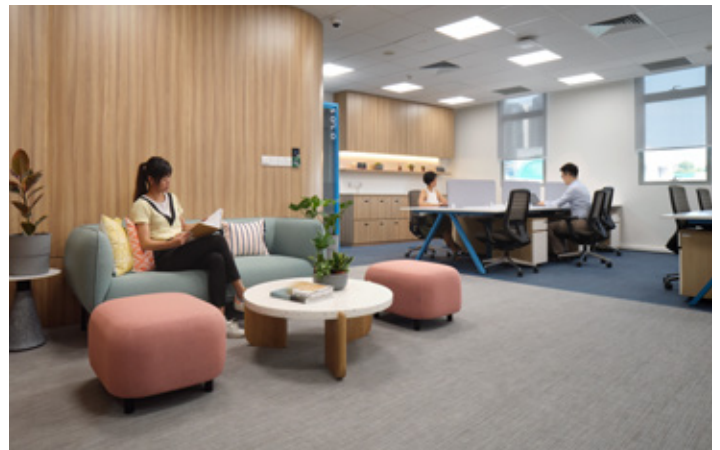

## Plug-and-Play Labs

Our 12m<sup>2</sup> to 14.5m<sup>2</sup> lab spaces are ideal for early-stage start-ups that have graduated from incubators to progress to their next milestones.



Private rooms within the lab each accommodate 3 to 5 people



Open lab with shared equipment



Tissue culture room



Storage spaces with shared general equipment

## HIGHLIGHTS

Digital microscope with AI cell count

Cell storage capabilities

BSC Hoods

CO<sup>2</sup> Incubators

ABS/Fluorescence/Lumi plate reader

Thermal Cycler, qRT-PCR

Imaging System



## FLOORPLAN

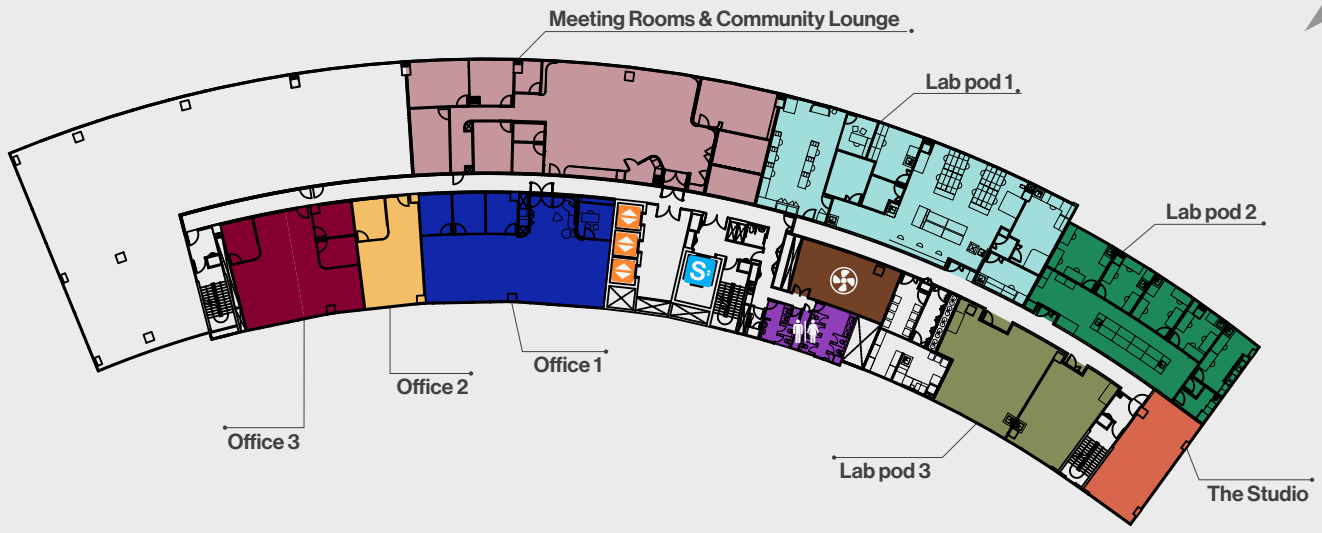

Shared event space/areas >4000 sf

Lab pods from 2500 – 3000 sf (10–20 ppl)



Toilet



Service Lift

Private office spaces from 1200 – 2000 sf (10–25 ppl)

Single desk availability



Passenger Lift



AHU Room

## TECHNICAL SPECIFICATIONS

Floor loading (kN/sqm): 5.0  
Floor to slab soffit height (m): 3.8

Passenger lifts: 3 x 1,020 kg (15 ppl)  
Service lift: 1 x 2,515 kg

Dimensions: 2.9 m (W) x 2.4 m (D) x 2.4 m (H)  
Lift car door size: 2.5 m (W) x 1.9 m (H)

## CONNECTIVITY

- Next to the **medical campus of Singapore's largest research university NUS & NUHS**
- 10 mins to **Singapore's largest public and academic medical cluster SGH and DUKE-NUS**
- Next to **Singapore's primary government lab site A\*STAR at one-north**
- 20 mins to **Singapore's 2<sup>nd</sup> largest research university NTU**

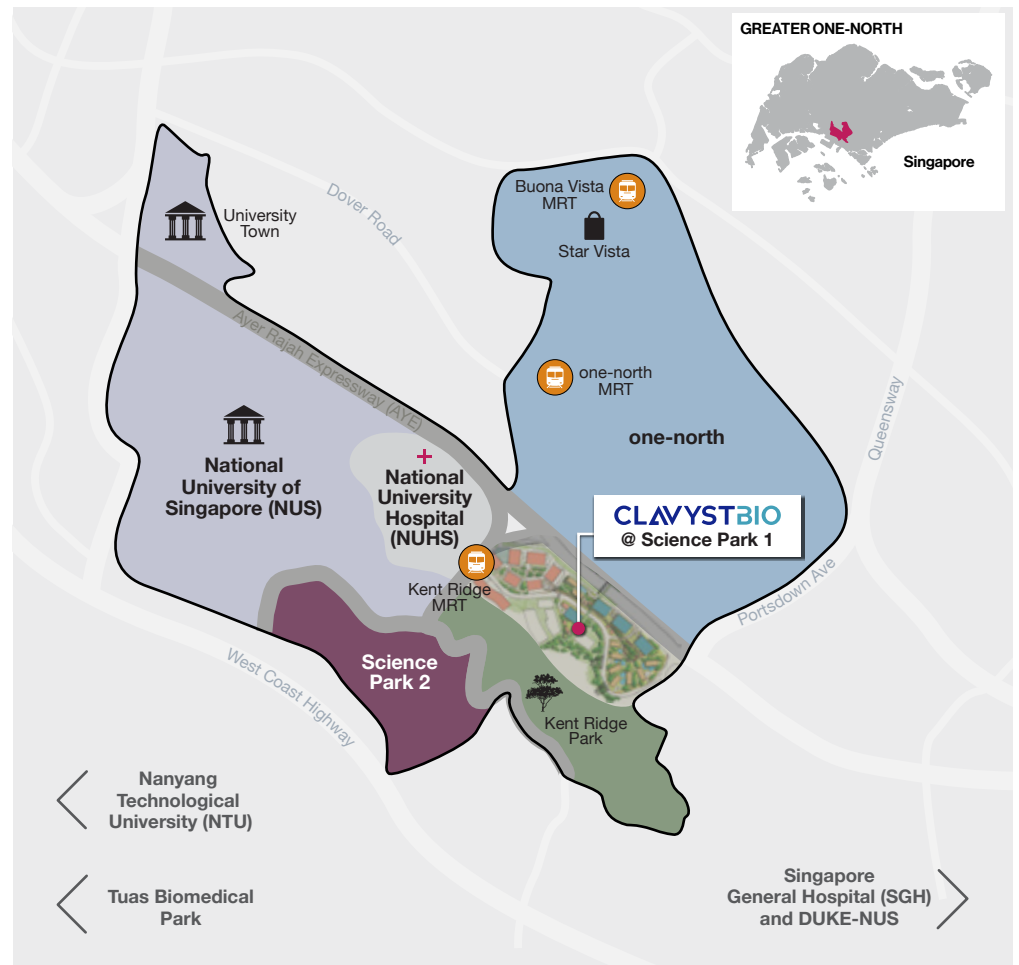

ClavystBio Pte Ltd makes no representations or warranties, conditions, undertakings or terms either expressed or implied as to the condition, quality, accuracy, fitness for purpose, completeness of the information contained herein or that such information will be accurate, up to date, or free from error. All art renderings and pictures herein are artist's impressions only and all specifications stated herein are subject to re-survey and approval from the relevant authorities. The information and specifications contained herein do not form part of an offer or a contract and neither ClavystBio Pte Ltd nor their appointed Marketing Agents can be held for any inaccuracies, changes, losses or damages arising therefrom.